

YourBrand.LearnSocial

Social Learning Platform
- General English:

Training Notes
for Students

Version: 2014 May 26

Contents

Login	3
Menus	4
Download for offline use	4
Navigation icons	5
Popup buttons	5
Exercise types	6
Matching	6
Text-entry	7
Record and Compare	7
Record and Compare - initial setup	7
Record and Compare – doing the exercise	7
Dropdown	8
Multiple-choice questions	8
Study Groups	9
Add new group	Error! Bookmark not defined.
Create new group	Error! Bookmark not defined.
View group	10
View Students' scores	Error! Bookmark not defined.
Delete a Student or Group	Error! Bookmark not defined.
Social exercise: Speaking (Audio)	11
Social exercise: Speaking (Audio) – initial set-up by students	11
Social exercise: Speaking (Audio) – how students do the exercise	11
Social exercise: Writing	13
Social exercise: Review	14
Social Exercise: My Learning	16
Improving an answer	17
Submit to teacher	17

The parts with a yellow background tint indicate something you might need to do once as part of setting up access or features etc.

Login

- Open your browser (*use the **Chrome browser** if you can: free from: www.google.com/chrome*)
- Go to <http://yourbrand.learnsoci.al>
- When you see this message (e.g. in yellow, at the top of the screen), **click OK**.
(This is to allow you to record audio and to save units to use offline when you do not have an internet connection.)

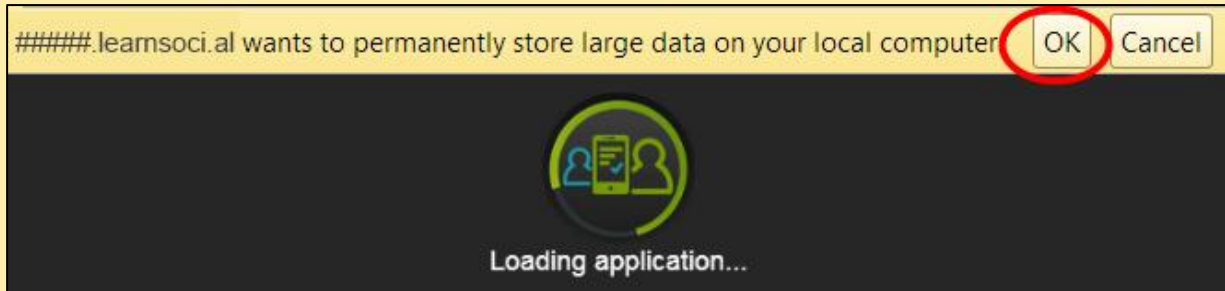

- The first time you use the platform you:
 - will see **Loading application** sign.
In future you will only have to wait for this when new units have been added.
 - need to **create an account**



The first time you use the platform, **create an account**.

You will not be able to login until you have created an account.

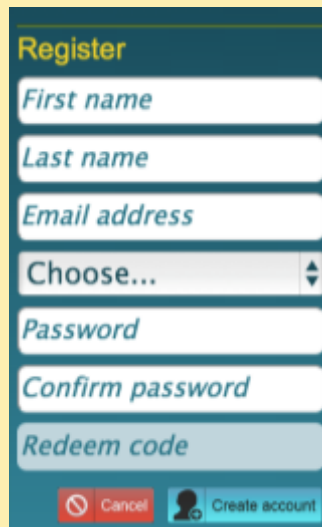

Register to create an account.
Fill out all the fields.
Your password for the platform must **be at least 8 characters**.

You will need your supplied **registration code** (“Redeem code”).
E.g. 5KHFVS373FM8DN65

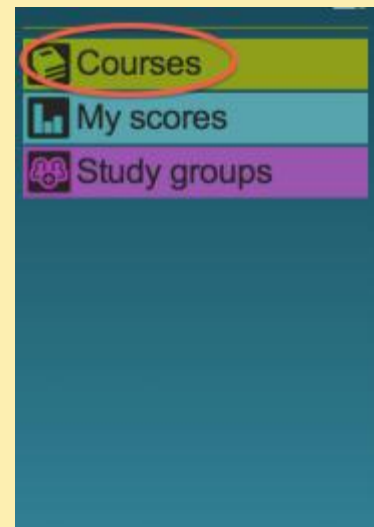

When you have finished you will automatically be taken to the main menu.
Click **Courses**

- In the future, you will only need to login using your email address and platform password

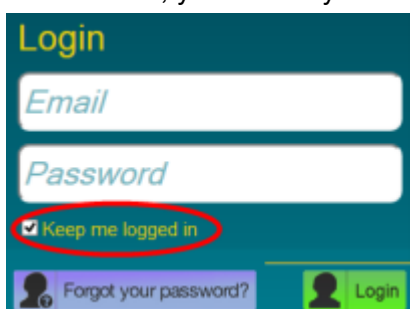

If you select **Keep me logged in**, you will not have to enter your email and platform password next time.

Select the **Login** button to enter the platform.

Menus

- Use the menu to choose the course, level and unit:

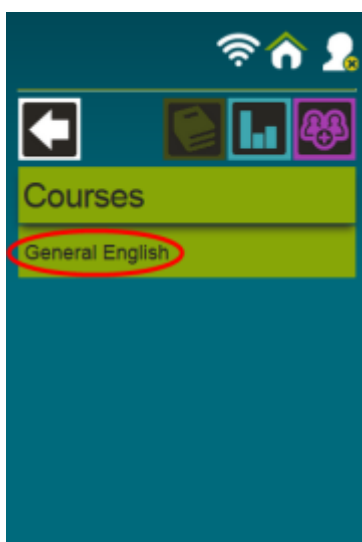

Click **General English**.

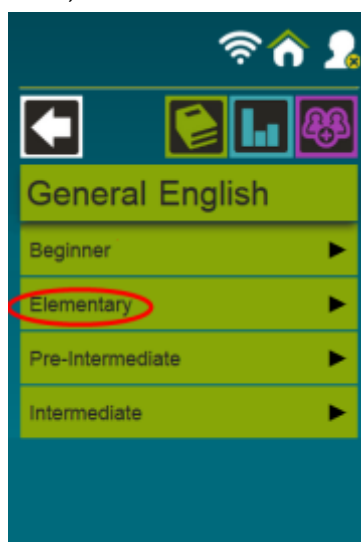

Click one of these levels:

Beginner
Elementary
Pre-Intermediate
Intermediate

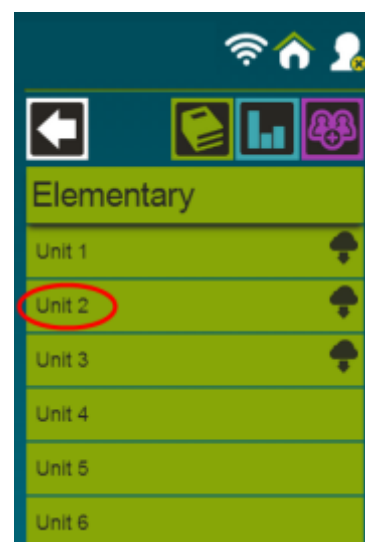

Click a unit name to try its exercises.

Each of the 4 levels has exercises initially for Units 1-9.

More units are added each week.

Download for offline use

If you click the cloud icon, you can download the unit. You can use a downloaded unit even if there is no internet connection.

Click this **enable offline** icon to start using downloaded units when there is no internet connection.

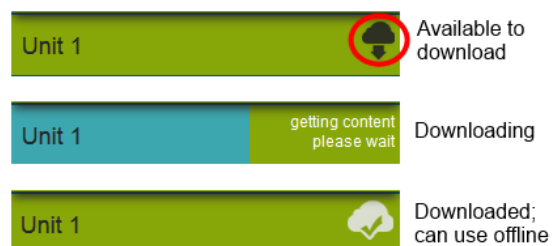



Navigation icons



To go **back to the previous menu**, use the back arrow.



To return to the **main menu**, click the top-middle icon (“home”).



To **log out**, click the top-right icon.

The first part of the unit lists the Unit Goals.

In this unit, you will practice the following.	
VOCABULARY:	jobs
DIALOGUE:	discussing your job and school
PRONUNCIATION:	question intonation

The first part of the unit lists the Unit Goals.

Click the arrow in the top-right corner, to move to the next page.

Initially, there are 4 levels (from Beginner to Intermediate) each with units 1-9.

New units will be added each week.

Popup buttons

Throughout the unit there are **popup buttons** to help learners:



Tips displays useful study tips.



Read displays a piece of text needed for the exercise.



Help displays extra information.



If there is a version of the main instruction translated into a local language (*e.g. Mandarin, Vietnamese, Spanish*), this button will display it.

Exercise types

Matching

Simple present review: Yes/no questions and short answers
Match the questions and answers.

Do you work on campus?	No, you're not.
Does he play soccer?	Yes, he does.
Am I in your English class?	No, I don't.
Is he single?	Yes, they do.
Do Sonja and Beatrice share an apartment?	No, he's not.

Reveal Reset Check

Select a phrase on the left and a phrase on the right.
The **selected words will move to the same row** and be highlighted in **green**.
Click the words again to deselect them to change your answer.

Click **Check** to see if your answer is correct.

Click **Reset** to clear your answers.

Click **Reveal** to see the correct answer.

Well done!
You have completed this part of the lesson.
Click on your scores to review your answers.

Page 1 : 2 out of 2	100%
Page 2 : 1 out of 2	50%
Page 3 : 2 out of 2	100%
Page 4 : 1 out of 2	50%

Total 75%

At the end of the section you can see your scores.

Click a **blue panel** to go back to that exercise to try again.

Text-entry

4. Someone from the United States is .

Click in the box and type your answer.

Record and Compare

Record and Compare - initial setup

The **first time** you use a “Record and Compare” Exercise, you have to **allow your browser to record your audio**. *Browser: Google Chrome* *Browser: FireFox*

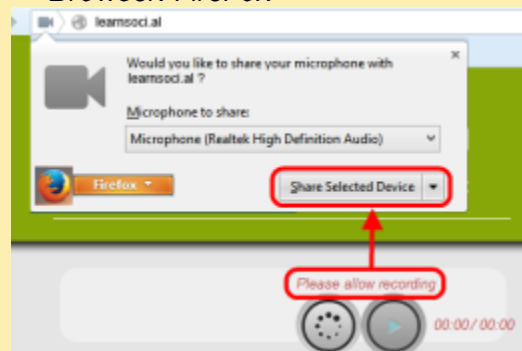
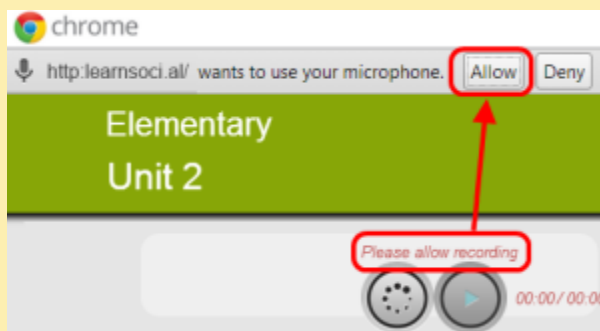

Record and Compare – doing the exercise

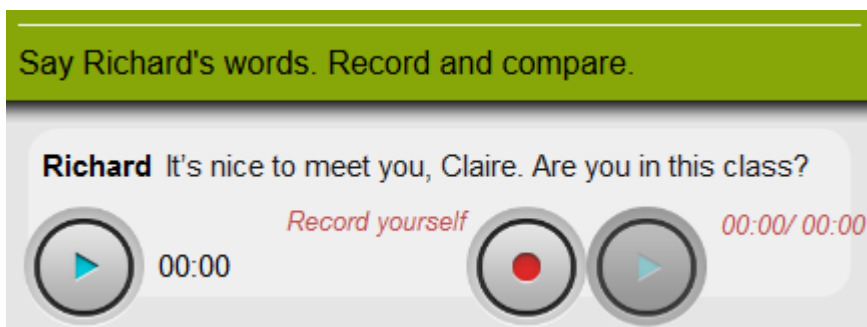

Listen to a recording by clicking the blue ► button on the left,

then click the red “Record” ● button to start recording an audio file of how you say the word(s)/phrase.

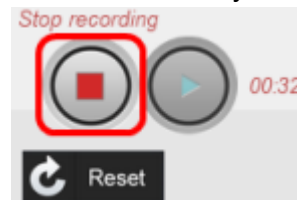

Click the red “Stop” ■ button to end your recording.

Click the blue “Play” ► button to listen to your recording, to compare your pronunciation to the original recording.

If you want to re-record your answer, click **Reset**

On some mobile devices, you will need to use its own recording app and select the file to submit it. On some iPhones you will be prompted “Video / Photos ?” – select “Video” to make your recording, then submit; the Platform will convert it to an audio file.

Dropdown

Listen. Then complete each sentence. Choose the correct word.



4. Nina works at a . She's the .

department store
drug store

daytime manager
assistant manager

Reset Check

Select choose and choose the correct word to complete the sentence.

Multiple-choice questions

Read the article. Then answer the questions.

HELLO. MY NAME IS...



Hello. My name is Elena. I am a student. I'm from Mexico. Now I live in the dorm at my school. My school is in England. I study art and English.



Hi. I'm Joaquin. I'm from the Philippines. I go to school in America. I speak three languages. I speak English, Spanish, and Chinese. I don't want to learn any more languages.



Hello. I'm Daiki. I'm a student. I live in Brazil. I go to school online. I have a big brother. He's in school too. His school is in Brazil. My school is in Japan.

1. _____ goes to school in England.

2. _____ speaks three languages.

3. _____ lives in Brazil.

Reset Check

Your **selected answer** is highlighted in **green**. You can click another word to change your answer.

Study Groups

Search/find group

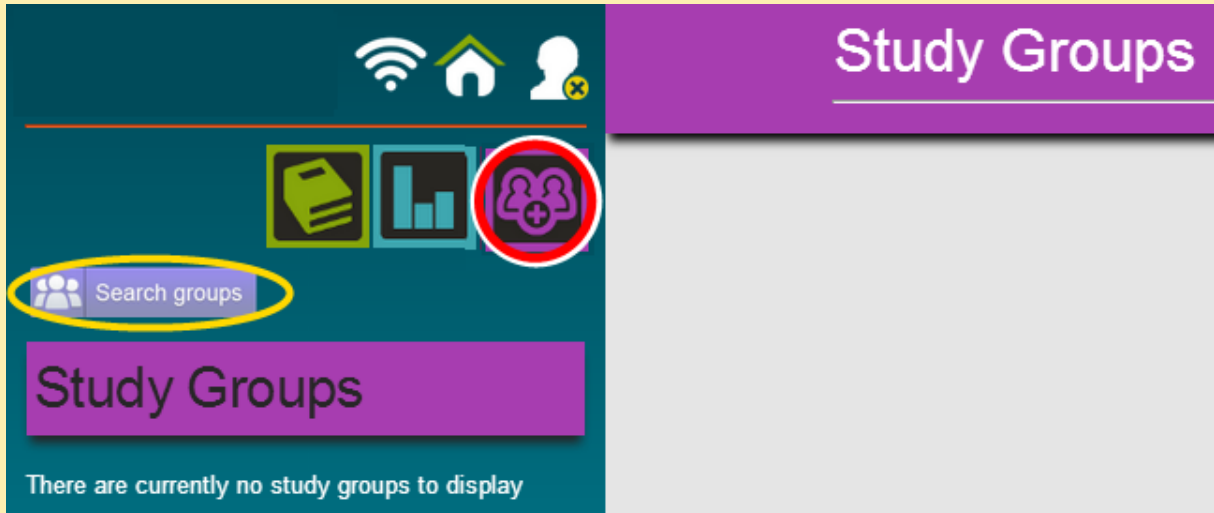

Click the **purple Study Groups** icon (highlighted in red) to **see** your Study Groups (classes).
Click **Search groups** (highlighted in yellow) to **find** a group.

Join a group

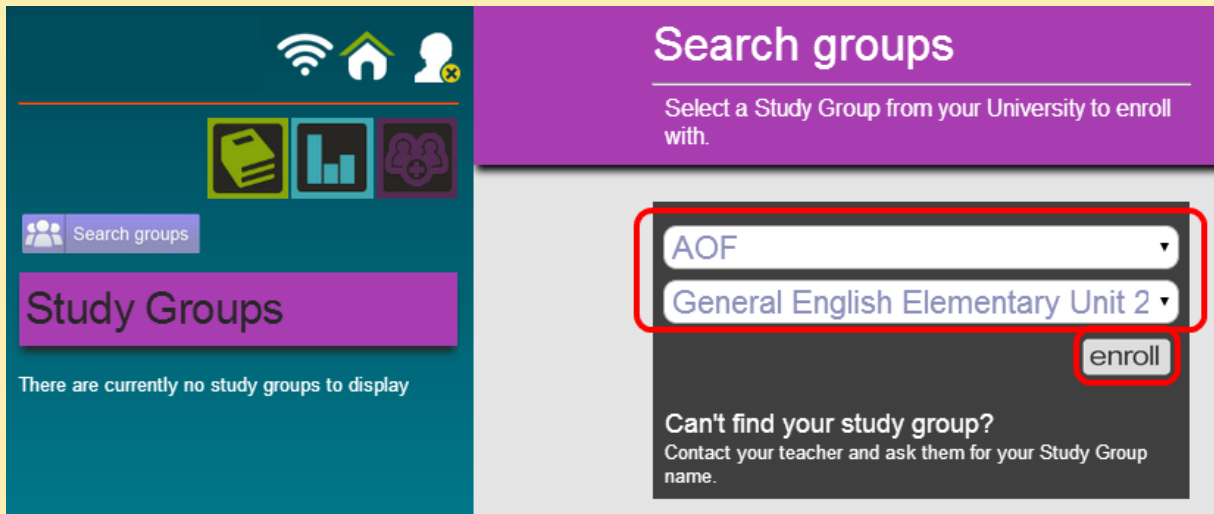

Select your university from the dropdown list.

Select the name of the group that your teacher tells you to join. Click **Enroll**.

You will then see **Enrollment successful** and the Study Group will appear in your list of **Study Groups** (see next page).

Select the purple panel for your Study Group (highlighted in yellow) to see the menu for View Group, My Learning and Review.

View group

Click **View group** (in menu highlighted in red).

If you want to **leave** the group click **Leave this group** (highlighted in yellow).

View Group

Social exercise: Speaking (Audio)

Social exercise: Speaking (Audio) – initial set-up

The **first time** you use a Speaking Exercise, you have to **allow the browser to record your audio**. *Browser: Google Chrome*

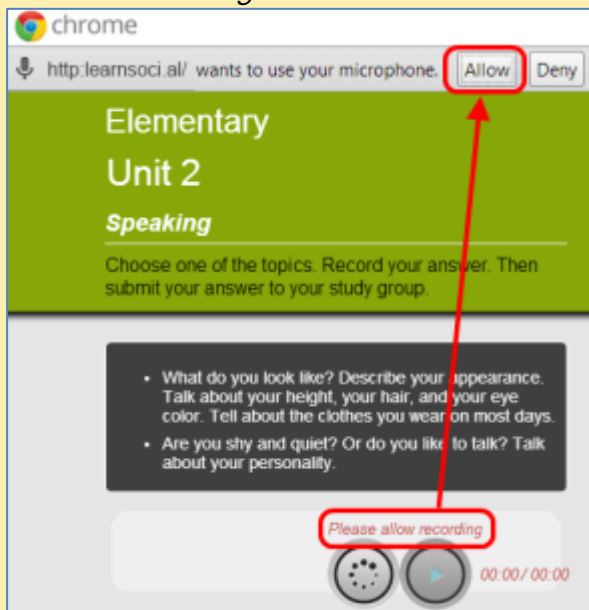

Browser: FireFox

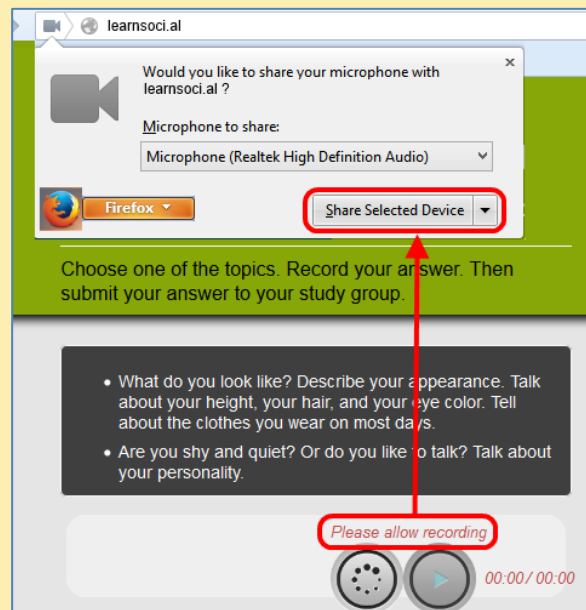

Social exercise: Speaking (Audio) – doing the exercise

8 Speaking

Choose one of the topics. Record your answer. Then submit your answer to your study group.

- What do you look like? Describe your appearance. Talk about your height, your hair, and your eye color. Tell about the clothes you wear on most days.
- Are you shy and quiet? Or do you like to talk? Talk about your personality.
- Describe a classmate. Talk about his or her appearance and personality. Don't say the name. Ask your classmates to guess who it is.

Record yourself

00:00 / 00:00

Reset

General English Elementary Unit 2 Submit

Click the red “Record” ● button to start recording an audio file of your own answer to the question.

Click the red “Stop” ■ button to end the audio file of your answer.

Click the blue “Play” ► button to listen to their audio file.

If you want to re-record their answer, they click **Reset**

Select your **Study group** from the dropdown list (highlighted in yellow) and click **Submit**

After you click that button it changes to **Submitted** and your answer is submitted to all the classmates in your study group.

The classmates can then give you feedback on your answer.

On some mobile devices, you will need to use its own recording app and select the file to submit it. On some iPhones you will be prompted “Video / Photos ?” – select “Video” to make your recording, then submit; the Platform will convert it to an audio file.

If using a computer/laptop some older versions of browsers might not able to record audio, so you will have to record the audio with another software program or app and then upload the file.

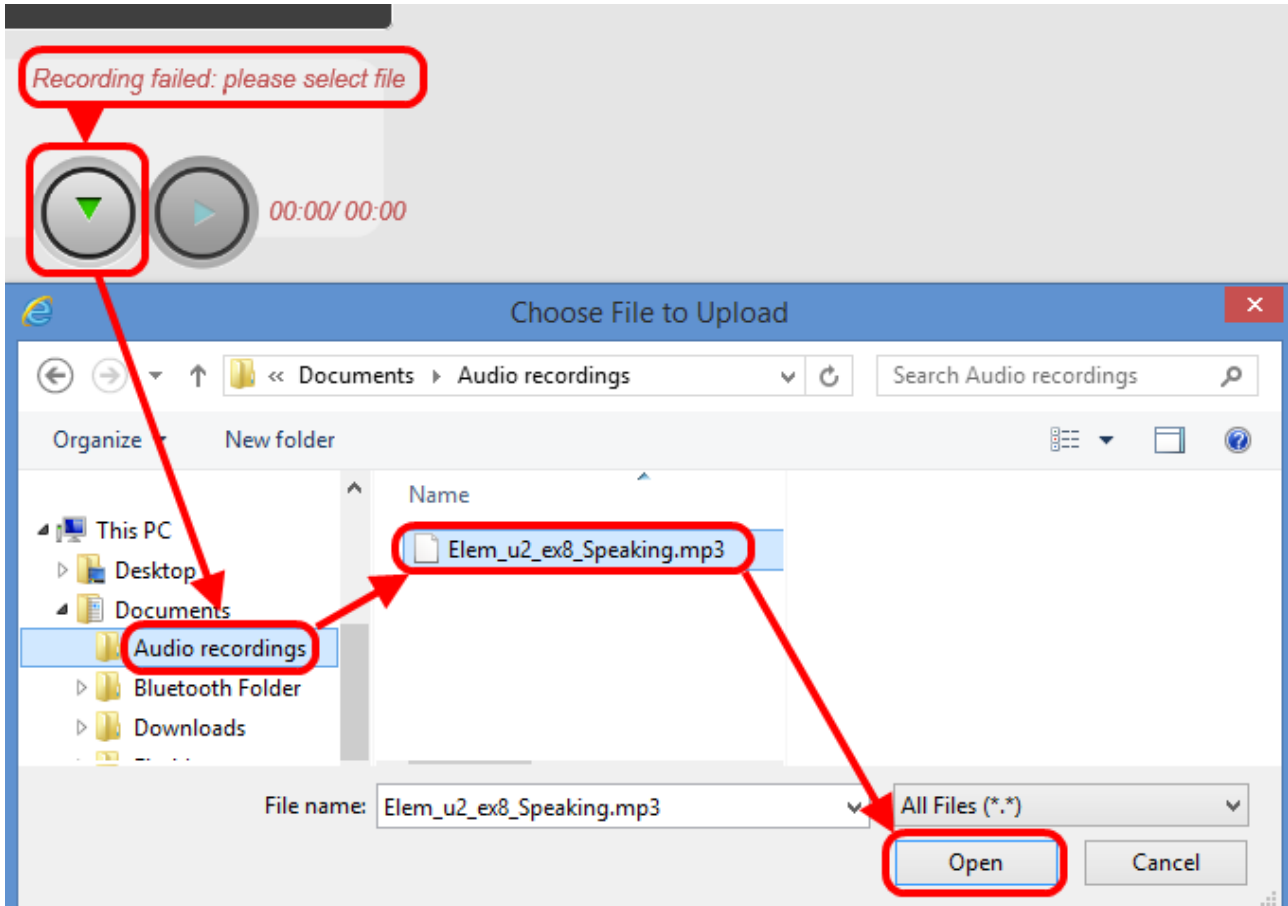

Social exercise: Writing

Elementary
Unit 2

9 Writing

Write about a friend or family member. Describe his or her appearance. State details about what he or she does look like. Also state what he or she doesn't look like. Follow the example. Then submit your description to your study group.

My sister's daughter is adorable. She has brown eyes. She has brown, curly hair. She does have a big smile. She doesn't have many teeth! She doesn't like to wear bows in her hair. She is getting tall.

 Reset

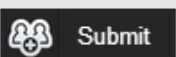
 Submit

Type in the box your answer to the question.

If you want to start again, click **Reset**

Select your **Study group** from the dropdown list (highlighted in yellow) and **click Submit**. After you click that button it changes to **Submitted** and your answer is submitted to all the classmates in your study group.

They can then give you feedback on your answer.

Social exercise: Review

Review List

This is a list of items submitted by students in your group. Take some time to review them and feedback.

[Name of student who submitted exercise]	Feedback Count
Unit 2 Writing - 2014 Apr 3 16:10	1
Unit 2 Speaking - 2014 Apr 6 15:15	0

In **Review** you can see the exercises submitted by the other students.

Click an answer to view and add feedback.

The number (highlighted in red) shows the number of times students have given feedback on that answer.

For a Speaking Exercise:

Unit 2 Speaking [Close]

Speaking

Review your classmate's response to the question below.

[Read] Read the question.

Version 1 of 1 [Report]

James

[Play] 00:00

Feedback [Text Box]

Student Feedback [Reset] [Submit]

Click the blue "Play" ► button to listen to the recording by the other student.

Give your **feedback** in the box.

Click **Submit** to provide your feedback to the student.

For a Writing Exercise:

The screenshot shows a user interface for a writing exercise. At the top, it says "Unit 2 Writing" with a "Close" button. Below that, it says "Writing" and "Review your classmate's response to the question below." There is a "Read" button. The main content area shows a student's response: "Pat" wrote "My friend is short and has black hairs. She is always happy and like to wear bright cloths." Below this is a "Feedback" section with a large empty text box. At the bottom right, there are "Reset" and "Submit" buttons. A red arrow points from the "Submit" button to the "Feedback" box.

Read the answer from the other student.

Give your **feedback** in the box.

Click **Submit** to provide your feedback to the student.

Social Exercise: My Learning

In My Learning you can see which of your submitted exercises have been reviewed by other students.

Blue panel: an exercise that **has been reviewed by other students**; the blue number shows the number of reviews **2**; click on the panel to view the feedback.

Orange panel: an exercise that has been submitted to the teacher and which is **waiting for marking (grading) by the teacher**.

Green panel: an exercise that **has been marked (graded)** by the teacher.



When you have feedback or want to improve your answer, or submit it to the teacher, click on a blue panel.

If you have feedback, you will see it below your answer.

Click the green triangle ▼ to expand the feedback.

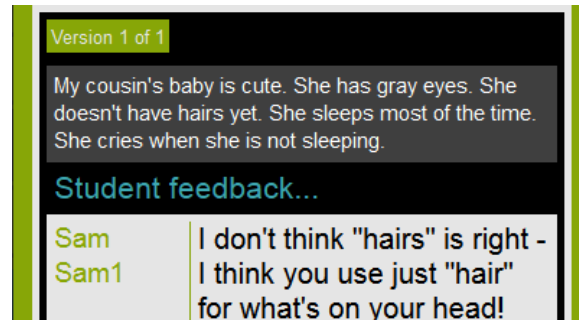
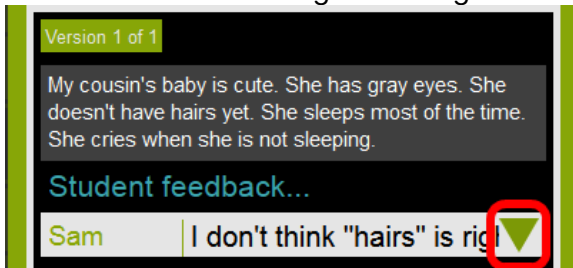

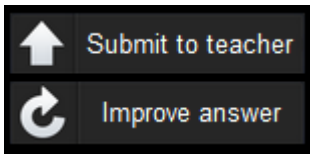

You can decide what to do next with your answer:

- **Submit to the teacher** for marking/grading
- **Improve the answer** and submit back to the group for more feedback

Improving an answer

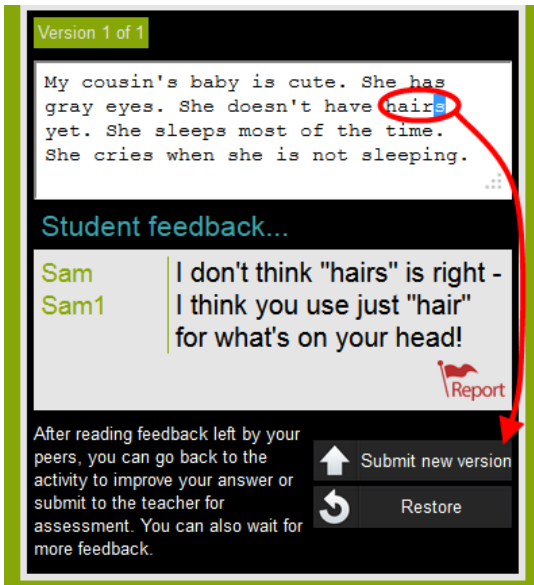

If you decide to improve the answer, it will be submitted to the Group for review: **Submit new version**

If you try to improve your answer, but decide to go back to your original answer, use **Restore**

Submit to teacher

When your answer is ready for marking (grading) select **Submit to the teacher** and select **Yes**

